

M/Y OBSESSION

An extraordinary yachting experience

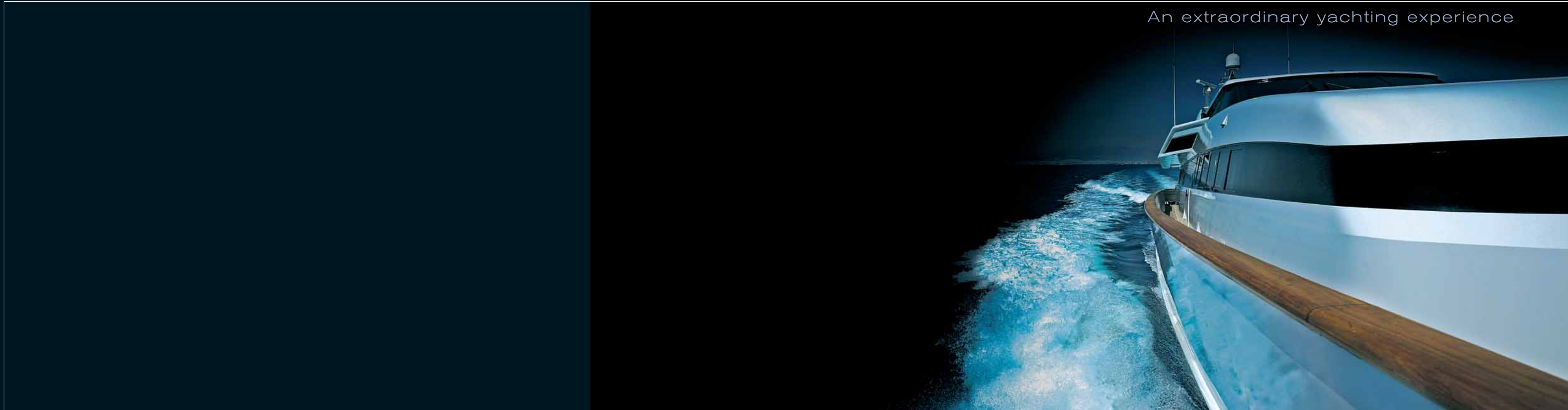

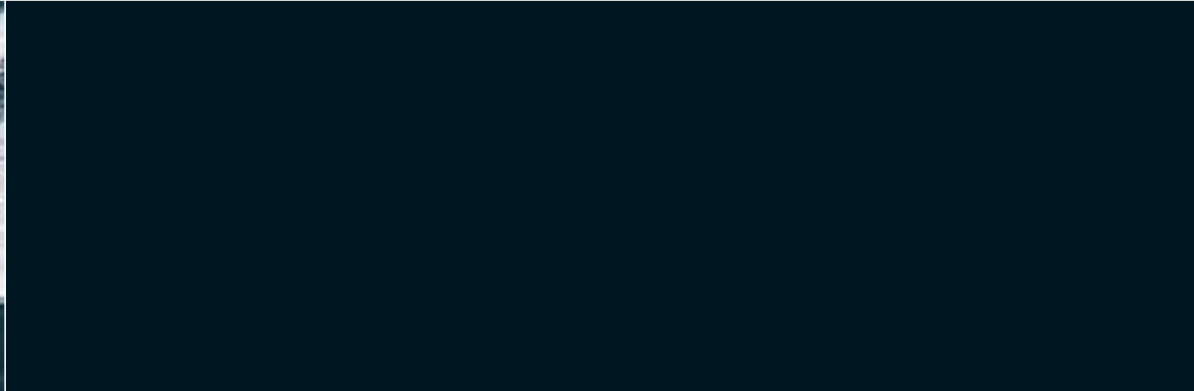

Obsesion means obsession in Spanish. M/Y "Obsesion" guarantees your experience on board to become an obsession. She is built by Baglietto shipyard in Italy, a shipyard with experience of 156 years in the industry. Obsesion is a 36.7 meter luxury motor yacht that combines performance and style cruising comfortably at 28 knots.





The spacious salon offers comfort and opulence, with 42" flat screen Plasma TV, play-station, state of the art Hi-Fi System and a game-table which may entertain you at anytime.





The dining area in the salon comfortably seats ten guests who may enjoy divine meals prepared by the superb Chef and served to by the exceptionally professional crew.





The two full beam Master and V.I.P cabins on the lower deck offer Queen sized bed, two seat sofa, vanity, spacious closet, Satellite TV/DVD/CD/Radio, en-suite facilities and air-conditioning throughout, pledge relaxation and pleasant dreams.



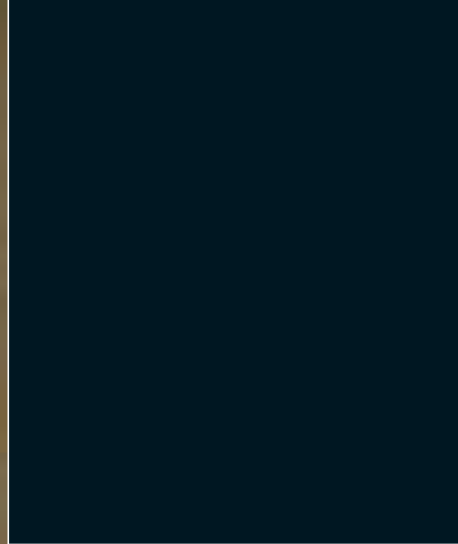

The two twin cabins are equally exquisite with refined wood and fabrics, very comfortable single beds, closet, radio/cd, en-suite facilities. An additional single cabin with Pullman bed can accommodate two more guests. All guest cabins are fully air-conditioned.

The sundeck, with the option of a bimini for a shade, offers generous sunbathing space during the day and romantic evenings under the stars. The shaded aft deck is ideal for guests' informal meals while the fore deck offers a discreetly secluded sun-bed. The spacious sea-level swimming platform provides easy access for all water activities.

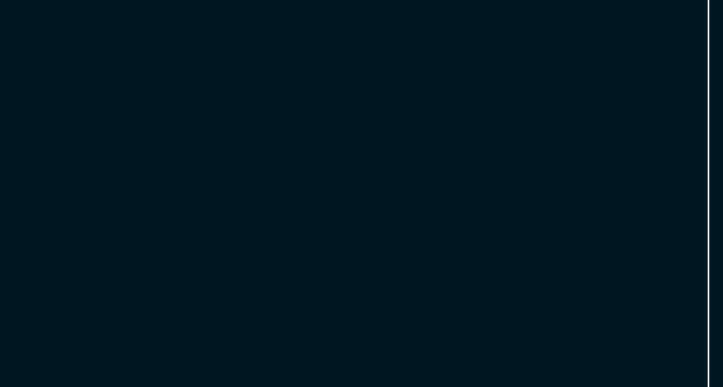
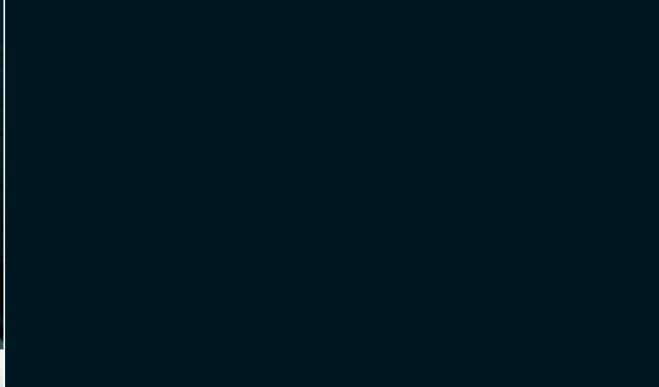

The outer main deck provides beautiful sunset dinners or morning breakfasts on the aft dining area. Additionally you can relax and sunbath in absolute privacy on the large sun lounge in fly bridge. Live your myth in the ultimate yachting enviroment. In M/Y Obsesion...





TECHNICAL SPECIFICATIONS

SPECIFICATIONS EQUIPMENT

Length: 36.7 Meters 120.4 Feet
 Beam: 7.2 Meters 23.6 Feet
 Draft: 2.4 Meters 7.9 Feet
 Number of crew: 5/6
 Built: 1990 Total refit: 2007
 Builder: Baglietto
 Flag: Greek
 Hull construction: Aluminium
 Engines: 2 x MTU 12V 396 TE94
 (2 x 2270 HP).
 Generators: 2 x ONAN - Cummings 2 x 48 KW.
 Cruising speed: 26
 Maximum Speed: 28
 Fuel Consumption: 800
 Electricity 220V, 24V
 Water Capacity: 4,700 Ltrs
 Fuel Capacity: 39,500 Ltrs

ACCOMMODATION

Ten guests in One Master cabin, One VIP cabin and Two Twin cabins and one cabin with upper and lower berths, all with en-suite facilities. Crew in separate quarters.

EQUIPMENT

All navigation features with Radar, GPS, plotters, Navtex, autopilot, VHF/DSC, EPIRB, GSM Telephone + Internet Connection, Inmarsat, Bow thruster, LOG/Speedometer, echo-sounder, SSB, weather-fax, searchlights, internal TV system and camera control, electronic engine instrumentation panels, air-conditioning throughout, water-maker, water-heater, icemakers, BBQ on sun deck and laundry facilities.

RECREATION

Home cinema on main deck salon with 42" TV, Satellite receiver, internet media-master with Audio/CD, Video and DVD. Tenders + toys: 1xNovurania 4.60m inflatable (rigd GRP hull) with 4 stroke Yamaha 100hp outboard engine. Jet ski Bombardier GTx4-Tec 1500cc/185hp. 1 diving air-compressor, 2 sets of diving gear, 1 flying cat, 2 tubes, kneeboard, wake-board, water-skis, banana and snorkeling.

ACCOMMODATION WATER SPORTS

Number of cabins: 5
 Cabin configuration: 2 Double,
 3 Twin
 Bed configuration: 1 Pullman,
 2 Queen,
 5 Single
 Number of guests: 10
 Tenders + toys: 1xNovurania 4.60m inflatable (rigd GRP hull) with 4 stroke Yamaha 100hp outboard engine. Jet ski Bombardier GTx4-Tec 1500cc/185hp. 1 diving air-compressor, 2 sets of diving gear, 1 flying cat, 2 tubes, kneeboard, wakeboard, water-skis snorkeling.

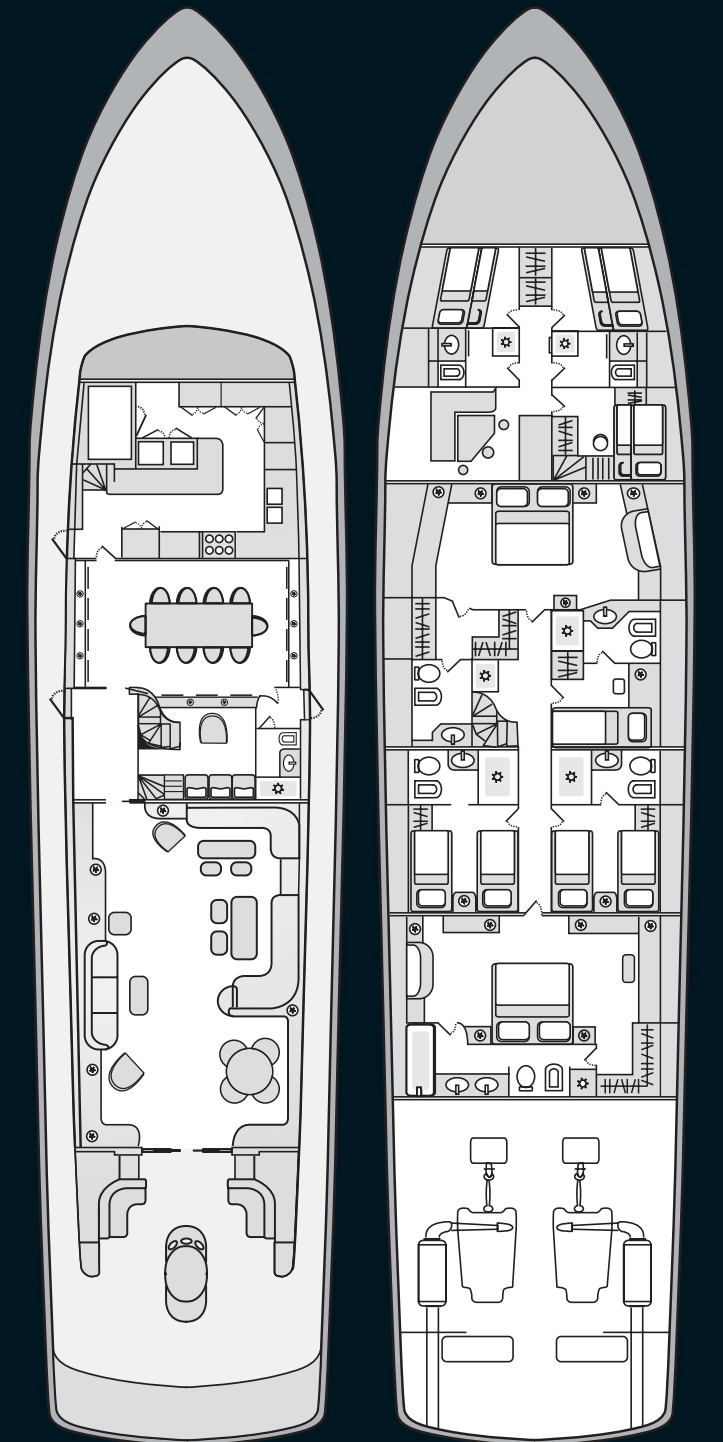



M/Y OBSESSION